



**Maryland
Environmental
Trust**

Protecting Land Forever

The logo is a green oval with a white border, containing the text "Maryland Environmental Trust" in white, bold, serif font.

Maryland Environmental Trust

Protecting Land Forever

- Only statewide land trust in Maryland
- One of the largest land trusts in the country
- Established by state legislation in 1967, accepted first easement donation in 1972
- Unit of the Department of Natural Resources, and governed by a citizen Board of Trustees
- Staff of 9, plus contractual and seasonal employees interns and volunteers
- Represented by MD Office of the Attorney General
- Close to 60% of easements co-held with local non-profit land trust partners

















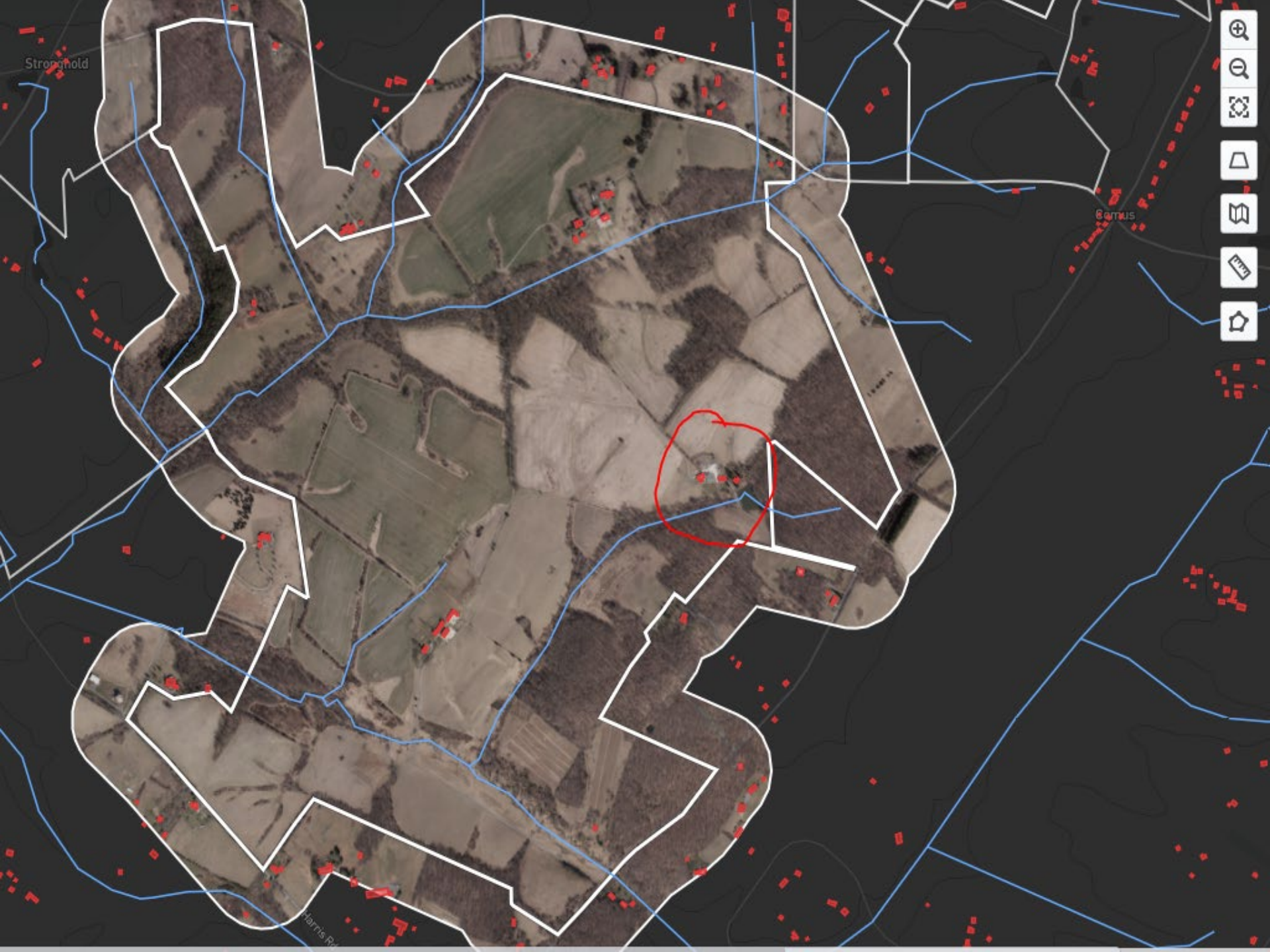

Stromhold

607115

Harris Rd



































Thank you!